

**SITE STATISTICS**

OVERALL LOT AREA	5,879m <sup>2</sup>	0.5879 Ha
LOT FRONTAGE (WELLINGTON)	250'-11"	76.49 m
OVERALL LOT COVERAGE	2144.91 m <sup>2</sup>	36.5%
OVERALL DENSITY	51.03 Unit/Ha	
OVERALL FLOOR SPACE INDEX(FSI)	1.04	
TOTAL GROSS FLOOR AREA	65,600 ft <sup>2</sup>	6,094 m <sup>2</sup>
NUMBER OF PARKING SPOT	66	
RESIDENT PARKING	30 (Enclosed) +30(On Driveway)	
VISITOR PARKING	6	
TOTAL NUMBER OF UNITS	30	

**SITE STATISTICS**

OVERALL LOT AREA	5,879m <sup>2</sup>	0.5879 Ha
OVERALL LOT COVERAGE	2144.91 m <sup>2</sup>	36.5%
ROAD & VISITOR PARKING AREA	1270.20 m <sup>2</sup>	
DRIVEWAYS AREA	706.36 m <sup>2</sup>	
SOFT LANDSCAPING AREA	1576.99 m <sup>2</sup>	
HARD LANDSCAPING AREA	1758.53 m <sup>2</sup>	

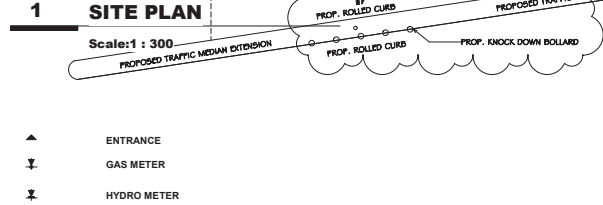
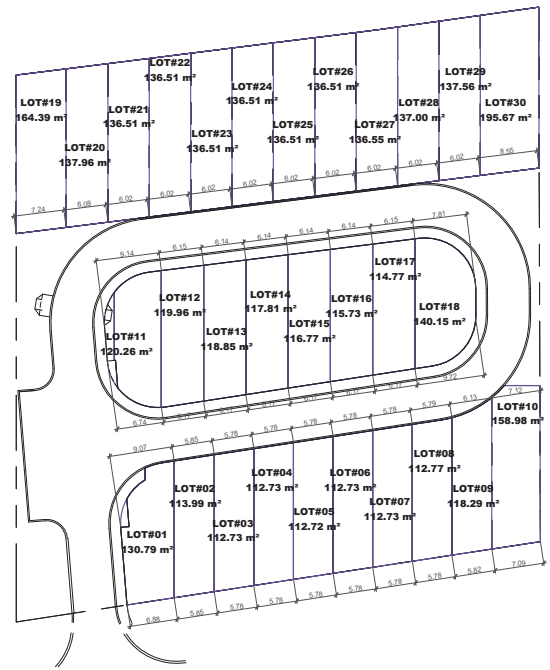

**TOWN OF AURORA APPROVED**  
DATE: Jul. 19, 2024  
*M. Romano*  
DIRECTOR OF PLANNING AND DEVELOPMENT SERVICES



**Livwell**  
on WELLINGTON

Project: **LIVWELL**  
AURORA ONTARIO

Submission Chart

1	1	23-04-30	2nd Submission
2	1	23-06-30	3rd Submission
3	1		
4	1		
5	1		
6	1		
7	1		
8	1		
9	1		

Revision Chart

No.	Date	Issued For	By
1	22-06-18	For Consultants	
2	22-06-23	Preliminary Site Plan	
3	22-07-04	Preliminary Site Plan	
4	22-09-01	For Consultants	
5			
6			
7			
8			
9			

All Drawings, Specifications and Related Documents are the property of Hyphen Studio Inc. the copyright in the same being reserved to them. Reproduction of Drawings, Specifications and Related Documents in part or whole is not permitted without the written permission of Hyphen Studio Inc. This drawing must not be scaled. The contractor is to verify dimensions and data noted herein with conditions on the site and is held responsible for reporting any discrepancy to Hyphen Studio Inc. for adjustment. This drawing is not to be used for Construction purpose until signed and sealed by the Architect.



**HYPHEN** STUDIO

3429 Yonge St., Toronto, ON, M4N 2N1  
info@hyphenstudio.ca  
(+1)647-869-9356 (+1)647-9796879

Sheet Title: **SITE PLAN**

Drawn	Author	Sheet No.
Checked	Checker	
Project No.	22-256	
Date	JUN 2022	<b>A01-00</b>
Scale	As Indicated	

All roadways must be constructed in accordance with the "Town of Aurora Design Criteria Manual for Engineering Plans"