

**TOWN OF AURORA
APPROVED**

DATE: _____

M. Ramona

**DIRECTOR OF PLANNING AND
DEVELOPMENT SERVICES**

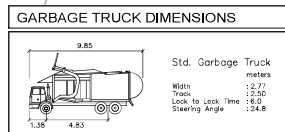

- GENERAL NOTES**
- GAS METERS SHALL NOT BE LOCATED ON BUILDING FACADES THAT FACE PUBLIC STREETS AND SHALL BE SCREENED FROM PUBLIC VIEW.
 - REFUSE GARBAGE TO BE STORED INTERNALLY AND REMOVED OFF-SITE BY PRIVATE CONTRACTOR.
 - ROOF TOP UNITS (RTUs) TO BE SCREENED FROM PUBLIC VIEW.

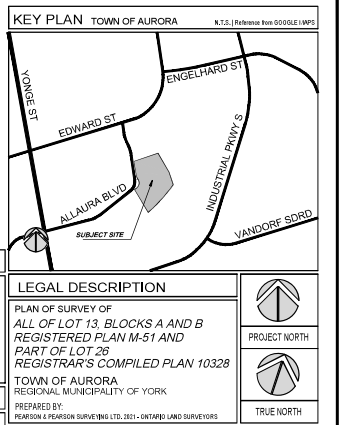

LEGAL DESCRIPTION

PLAN OF SURVEY OF ALL OF LOT 13, BLOCKS A AND B REGISTERED PLAN M-51 AND PART OF LOT 26 REGISTRAR'S COMPILED PLAN 10328

TOWN OF AURORA REGIONAL MUNICIPALITY OF YORK PREPARED BY PEARSON & PEARSON SURVEYING LTD. 3001 - ONTARIO LAND SURVEYORS

SYMBOL LEGEND

- MAN DOOR LOCATIONS
- LOADING DOCK LOCATIONS
- DRY-DRAIN OVERHEAD DOORS
- HYDRANT VALVE
- CONC. FILLED STEEL BOLLARD
- SIAMSESE CONNECTION
- FIRE ROUTE
- STOP SIGN
- LIGHT STANDARD
- BI-CYCLE RACKS
- ACCESSIBLE PARKING
- CURB DEPRESSION, BARRIER FREE ACCESS
- GAS METERS

OBC MATRIX - BUILDING 'A'

Firm Name: Baldassarra Architects Inc. Certificate of Practice Number: 5810
Address: 1000 SHEPPARD AVE. E. UNIT 107 SCARBOROUGH, ONT. M1B 4E7
Phone: (416) 291-7575

Name of Project: Garden Commercial Building 'A' Aurora, Ontario
Location: _____

Ontario 2012 Building Code Data Matrix Part 3

PROJECT DESCRIPTION	OBC Reference	PROJECT DESCRIPTION	OBC Reference
USE <td>SECTION 3.1</td> <td>USE <td>SECTION 3.1</td> </td>	SECTION 3.1	USE <td>SECTION 3.1</td>	SECTION 3.1
CHANGE OF USE <td>SECTION 3.2</td> <td>CHANGE OF USE <td>SECTION 3.2</td> </td>	SECTION 3.2	CHANGE OF USE <td>SECTION 3.2</td>	SECTION 3.2
MAJOR OCCUPANCY GROUP <td>SECTION 3.3</td> <td>MAJOR OCCUPANCY GROUP <td>SECTION 3.3</td> </td>	SECTION 3.3	MAJOR OCCUPANCY GROUP <td>SECTION 3.3</td>	SECTION 3.3
MINOR OCCUPANCY GROUP <td>SECTION 3.4</td> <td>MINOR OCCUPANCY GROUP <td>SECTION 3.4</td> </td>	SECTION 3.4	MINOR OCCUPANCY GROUP <td>SECTION 3.4</td>	SECTION 3.4
STORY AREA <td>SECTION 3.5</td> <td>STORY AREA <td>SECTION 3.5</td> </td>	SECTION 3.5	STORY AREA <td>SECTION 3.5</td>	SECTION 3.5
FLOOR AREA <td>SECTION 3.6</td> <td>FLOOR AREA <td>SECTION 3.6</td> </td>	SECTION 3.6	FLOOR AREA <td>SECTION 3.6</td>	SECTION 3.6
HEIGHT OF BUILDING <td>SECTION 3.7</td> <td>HEIGHT OF BUILDING <td>SECTION 3.7</td> </td>	SECTION 3.7	HEIGHT OF BUILDING <td>SECTION 3.7</td>	SECTION 3.7
HEIGHT OF SIGN <td>SECTION 3.8</td> <td>HEIGHT OF SIGN <td>SECTION 3.8</td> </td>	SECTION 3.8	HEIGHT OF SIGN <td>SECTION 3.8</td>	SECTION 3.8
NUMBER OF STOREY PROPOSED <td>SECTION 3.9</td> <td>NUMBER OF STOREY PROPOSED <td>SECTION 3.9</td> </td>	SECTION 3.9	NUMBER OF STOREY PROPOSED <td>SECTION 3.9</td>	SECTION 3.9
STAIRS REQUIRED <td>SECTION 3.10</td> <td>STAIRS REQUIRED <td>SECTION 3.10</td> </td>	SECTION 3.10	STAIRS REQUIRED <td>SECTION 3.10</td>	SECTION 3.10
ELEVATOR REQUIRED <td>SECTION 3.11</td> <td>ELEVATOR REQUIRED <td>SECTION 3.11</td> </td>	SECTION 3.11	ELEVATOR REQUIRED <td>SECTION 3.11</td>	SECTION 3.11
PERMITTED CONSTRUCTION <td>SECTION 3.12</td> <td>PERMITTED CONSTRUCTION <td>SECTION 3.12</td> </td>	SECTION 3.12	PERMITTED CONSTRUCTION <td>SECTION 3.12</td>	SECTION 3.12
REQUIREMENTS <td>SECTION 3.13</td> <td>REQUIREMENTS <td>SECTION 3.13</td> </td>	SECTION 3.13	REQUIREMENTS <td>SECTION 3.13</td>	SECTION 3.13
REQUIREMENTS <td>SECTION 3.14</td> <td>REQUIREMENTS <td>SECTION 3.14</td> </td>	SECTION 3.14	REQUIREMENTS <td>SECTION 3.14</td>	SECTION 3.14
REQUIREMENTS <td>SECTION 3.15</td> <td>REQUIREMENTS <td>SECTION 3.15</td> </td>	SECTION 3.15	REQUIREMENTS <td>SECTION 3.15</td>	SECTION 3.15
REQUIREMENTS <td>SECTION 3.16</td> <td>REQUIREMENTS <td>SECTION 3.16</td> </td>	SECTION 3.16	REQUIREMENTS <td>SECTION 3.16</td>	SECTION 3.16
REQUIREMENTS <td>SECTION 3.17</td> <td>REQUIREMENTS <td>SECTION 3.17</td> </td>	SECTION 3.17	REQUIREMENTS <td>SECTION 3.17</td>	SECTION 3.17
REQUIREMENTS <td>SECTION 3.18</td> <td>REQUIREMENTS <td>SECTION 3.18</td> </td>	SECTION 3.18	REQUIREMENTS <td>SECTION 3.18</td>	SECTION 3.18
REQUIREMENTS <td>SECTION 3.19</td> <td>REQUIREMENTS <td>SECTION 3.19</td> </td>	SECTION 3.19	REQUIREMENTS <td>SECTION 3.19</td>	SECTION 3.19
REQUIREMENTS <td>SECTION 3.20</td> <td>REQUIREMENTS <td>SECTION 3.20</td> </td>	SECTION 3.20	REQUIREMENTS <td>SECTION 3.20</td>	SECTION 3.20
REQUIREMENTS <td>SECTION 3.21</td> <td>REQUIREMENTS <td>SECTION 3.21</td> </td>	SECTION 3.21	REQUIREMENTS <td>SECTION 3.21</td>	SECTION 3.21
REQUIREMENTS <td>SECTION 3.22</td> <td>REQUIREMENTS <td>SECTION 3.22</td> </td>	SECTION 3.22	REQUIREMENTS <td>SECTION 3.22</td>	SECTION 3.22
REQUIREMENTS <td>SECTION 3.23</td> <td>REQUIREMENTS <td>SECTION 3.23</td> </td>	SECTION 3.23	REQUIREMENTS <td>SECTION 3.23</td>	SECTION 3.23
REQUIREMENTS <td>SECTION 3.24</td> <td>REQUIREMENTS <td>SECTION 3.24</td> </td>	SECTION 3.24	REQUIREMENTS <td>SECTION 3.24</td>	SECTION 3.24
REQUIREMENTS <td>SECTION 3.25</td> <td>REQUIREMENTS <td>SECTION 3.25</td> </td>	SECTION 3.25	REQUIREMENTS <td>SECTION 3.25</td>	SECTION 3.25
REQUIREMENTS <td>SECTION 3.26</td> <td>REQUIREMENTS <td>SECTION 3.26</td> </td>	SECTION 3.26	REQUIREMENTS <td>SECTION 3.26</td>	SECTION 3.26
REQUIREMENTS <td>SECTION 3.27</td> <td>REQUIREMENTS <td>SECTION 3.27</td> </td>	SECTION 3.27	REQUIREMENTS <td>SECTION 3.27</td>	SECTION 3.27
REQUIREMENTS <td>SECTION 3.28</td> <td>REQUIREMENTS <td>SECTION 3.28</td> </td>	SECTION 3.28	REQUIREMENTS <td>SECTION 3.28</td>	SECTION 3.28
REQUIREMENTS <td>SECTION 3.29</td> <td>REQUIREMENTS <td>SECTION 3.29</td> </td>	SECTION 3.29	REQUIREMENTS <td>SECTION 3.29</td>	SECTION 3.29
REQUIREMENTS <td>SECTION 3.30</td> <td>REQUIREMENTS <td>SECTION 3.30</td> </td>	SECTION 3.30	REQUIREMENTS <td>SECTION 3.30</td>	SECTION 3.30
REQUIREMENTS <td>SECTION 3.31</td> <td>REQUIREMENTS <td>SECTION 3.31</td> </td>	SECTION 3.31	REQUIREMENTS <td>SECTION 3.31</td>	SECTION 3.31
REQUIREMENTS <td>SECTION 3.32</td> <td>REQUIREMENTS <td>SECTION 3.32</td> </td>	SECTION 3.32	REQUIREMENTS <td>SECTION 3.32</td>	SECTION 3.32
REQUIREMENTS <td>SECTION 3.33</td> <td>REQUIREMENTS <td>SECTION 3.33</td> </td>	SECTION 3.33	REQUIREMENTS <td>SECTION 3.33</td>	SECTION 3.33
REQUIREMENTS <td>SECTION 3.34</td> <td>REQUIREMENTS <td>SECTION 3.34</td> </td>	SECTION 3.34	REQUIREMENTS <td>SECTION 3.34</td>	SECTION 3.34
REQUIREMENTS <td>SECTION 3.35</td> <td>REQUIREMENTS <td>SECTION 3.35</td> </td>	SECTION 3.35	REQUIREMENTS <td>SECTION 3.35</td>	SECTION 3.35
REQUIREMENTS <td>SECTION 3.36</td> <td>REQUIREMENTS <td>SECTION 3.36</td> </td>	SECTION 3.36	REQUIREMENTS <td>SECTION 3.36</td>	SECTION 3.36
REQUIREMENTS <td>SECTION 3.37</td> <td>REQUIREMENTS <td>SECTION 3.37</td> </td>	SECTION 3.37	REQUIREMENTS <td>SECTION 3.37</td>	SECTION 3.37
REQUIREMENTS <td>SECTION 3.38</td> <td>REQUIREMENTS <td>SECTION 3.38</td> </td>	SECTION 3.38	REQUIREMENTS <td>SECTION 3.38</td>	SECTION 3.38
REQUIREMENTS <td>SECTION 3.39</td> <td>REQUIREMENTS <td>SECTION 3.39</td> </td>	SECTION 3.39	REQUIREMENTS <td>SECTION 3.39</td>	SECTION 3.39
REQUIREMENTS <td>SECTION 3.40</td> <td>REQUIREMENTS <td>SECTION 3.40</td> </td>	SECTION 3.40	REQUIREMENTS <td>SECTION 3.40</td>	SECTION 3.40
REQUIREMENTS <td>SECTION 3.41</td> <td>REQUIREMENTS <td>SECTION 3.41</td> </td>	SECTION 3.41	REQUIREMENTS <td>SECTION 3.41</td>	SECTION 3.41
REQUIREMENTS <td>SECTION 3.42</td> <td>REQUIREMENTS <td>SECTION 3.42</td> </td>	SECTION 3.42	REQUIREMENTS <td>SECTION 3.42</td>	SECTION 3.42
REQUIREMENTS <td>SECTION 3.43</td> <td>REQUIREMENTS <td>SECTION 3.43</td> </td>	SECTION 3.43	REQUIREMENTS <td>SECTION 3.43</td>	SECTION 3.43
REQUIREMENTS <td>SECTION 3.44</td> <td>REQUIREMENTS <td>SECTION 3.44</td> </td>	SECTION 3.44	REQUIREMENTS <td>SECTION 3.44</td>	SECTION 3.44
REQUIREMENTS <td>SECTION 3.45</td> <td>REQUIREMENTS <td>SECTION 3.45</td> </td>	SECTION 3.45	REQUIREMENTS <td>SECTION 3.45</td>	SECTION 3.45
REQUIREMENTS <td>SECTION 3.46</td> <td>REQUIREMENTS <td>SECTION 3.46</td> </td>	SECTION 3.46	REQUIREMENTS <td>SECTION 3.46</td>	SECTION 3.46
REQUIREMENTS <td>SECTION 3.47</td> <td>REQUIREMENTS <td>SECTION 3.47</td> </td>	SECTION 3.47	REQUIREMENTS <td>SECTION 3.47</td>	SECTION 3.47
REQUIREMENTS <td>SECTION 3.48</td> <td>REQUIREMENTS <td>SECTION 3.48</td> </td>	SECTION 3.48	REQUIREMENTS <td>SECTION 3.48</td>	SECTION 3.48
REQUIREMENTS <td>SECTION 3.49</td> <td>REQUIREMENTS <td>SECTION 3.49</td> </td>	SECTION 3.49	REQUIREMENTS <td>SECTION 3.49</td>	SECTION 3.49
REQUIREMENTS <td>SECTION 3.50</td> <td>REQUIREMENTS <td>SECTION 3.50</td> </td>	SECTION 3.50	REQUIREMENTS <td>SECTION 3.50</td>	SECTION 3.50
REQUIREMENTS <td>SECTION 3.51</td> <td>REQUIREMENTS <td>SECTION 3.51</td> </td>	SECTION 3.51	REQUIREMENTS <td>SECTION 3.51</td>	SECTION 3.51
REQUIREMENTS <td>SECTION 3.52</td> <td>REQUIREMENTS <td>SECTION 3.52</td> </td>	SECTION 3.52	REQUIREMENTS <td>SECTION 3.52</td>	SECTION 3.52
REQUIREMENTS <td>SECTION 3.53</td> <td>REQUIREMENTS <td>SECTION 3.53</td> </td>	SECTION 3.53	REQUIREMENTS <td>SECTION 3.53</td>	SECTION 3.53
REQUIREMENTS <td>SECTION 3.54</td> <td>REQUIREMENTS <td>SECTION 3.54</td> </td>	SECTION 3.54	REQUIREMENTS <td>SECTION 3.54</td>	SECTION 3.54
REQUIREMENTS <td>SECTION 3.55</td> <td>REQUIREMENTS <td>SECTION 3.55</td> </td>	SECTION 3.55	REQUIREMENTS <td>SECTION 3.55</td>	SECTION 3.55
REQUIREMENTS <td>SECTION 3.56</td> <td>REQUIREMENTS <td>SECTION 3.56</td> </td>	SECTION 3.56	REQUIREMENTS <td>SECTION 3.56</td>	SECTION 3.56
REQUIREMENTS <td>SECTION 3.57</td> <td>REQUIREMENTS <td>SECTION 3.57</td> </td>	SECTION 3.57	REQUIREMENTS <td>SECTION 3.57</td>	SECTION 3.57
REQUIREMENTS <td>SECTION 3.58</td> <td>REQUIREMENTS <td>SECTION 3.58</td> </td>	SECTION 3.58	REQUIREMENTS <td>SECTION 3.58</td>	SECTION 3.58
REQUIREMENTS <td>SECTION 3.59</td> <td>REQUIREMENTS <td>SECTION 3.59</td> </td>	SECTION 3.59	REQUIREMENTS <td>SECTION 3.59</td>	SECTION 3.59
REQUIREMENTS <td>SECTION 3.60</td> <td>REQUIREMENTS <td>SECTION 3.60</td> </td>	SECTION 3.60	REQUIREMENTS <td>SECTION 3.60</td>	SECTION 3.60
REQUIREMENTS <td>SECTION 3.61</td> <td>REQUIREMENTS <td>SECTION 3.61</td> </td>	SECTION 3.61	REQUIREMENTS <td>SECTION 3.61</td>	SECTION 3.61
REQUIREMENTS <td>SECTION 3.62</td> <td>REQUIREMENTS <td>SECTION 3.62</td> </td>	SECTION 3.62	REQUIREMENTS <td>SECTION 3.62</td>	SECTION 3.62
REQUIREMENTS <td>SECTION 3.63</td> <td>REQUIREMENTS <td>SECTION 3.63</td> </td>	SECTION 3.63	REQUIREMENTS <td>SECTION 3.63</td>	SECTION 3.63
REQUIREMENTS <td>SECTION 3.64</td> <td>REQUIREMENTS <td>SECTION 3.64</td> </td>	SECTION 3.64	REQUIREMENTS <td>SECTION 3.64</td>	SECTION 3.64
REQUIREMENTS <td>SECTION 3.65</td> <td>REQUIREMENTS <td>SECTION 3.65</td> </td>	SECTION 3.65	REQUIREMENTS <td>SECTION 3.65</td>	SECTION 3.65
REQUIREMENTS <td>SECTION 3.66</td> <td>REQUIREMENTS <td>SECTION 3.66</td> </td>	SECTION 3.66	REQUIREMENTS <td>SECTION 3.66</td>	SECTION 3.66
REQUIREMENTS <td>SECTION 3.67</td> <td>REQUIREMENTS <td>SECTION 3.67</td> </td>	SECTION 3.67	REQUIREMENTS <td>SECTION 3.67</td>	SECTION 3.67
REQUIREMENTS <td>SECTION 3.68</td> <td>REQUIREMENTS <td>SECTION 3.68</td> </td>	SECTION 3.68	REQUIREMENTS <td>SECTION 3.68</td>	SECTION 3.68
REQUIREMENTS <td>SECTION 3.69</td> <td>REQUIREMENTS <td>SECTION 3.69</td> </td>	SECTION 3.69	REQUIREMENTS <td>SECTION 3.69</td>	SECTION 3.69
REQUIREMENTS <td>SECTION 3.70</td> <td>REQUIREMENTS <td>SECTION 3.70</td> </td>	SECTION 3.70	REQUIREMENTS <td>SECTION 3.70</td>	SECTION 3.70
REQUIREMENTS <td>SECTION 3.71</td> <td>REQUIREMENTS <td>SECTION 3.71</td> </td>	SECTION 3.71	REQUIREMENTS <td>SECTION 3.71</td>	SECTION 3.71
REQUIREMENTS <td>SECTION 3.72</td> <td>REQUIREMENTS <td>SECTION 3.72</td> </td>	SECTION 3.72	REQUIREMENTS <td>SECTION 3.72</td>	SECTION 3.72
REQUIREMENTS <td>SECTION 3.73</td> <td>REQUIREMENTS <td>SECTION 3.73</td> </td>	SECTION 3.73	REQUIREMENTS <td>SECTION 3.73</td>	SECTION 3.73
REQUIREMENTS <td>SECTION 3.74</td> <td>REQUIREMENTS <td>SECTION 3.74</td> </td>	SECTION 3.74	REQUIREMENTS <td>SECTION 3.74</td>	SECTION 3.74
REQUIREMENTS <td>SECTION 3.75</td> <td>REQUIREMENTS <td>SECTION 3.75</td> </td>	SECTION 3.75	REQUIREMENTS <td>SECTION 3.75</td>	SECTION 3.75
REQUIREMENTS <td>SECTION 3.76</td> <td>REQUIREMENTS <td>SECTION 3.76</td> </td>	SECTION 3.76	REQUIREMENTS <td>SECTION 3.76</td>	SECTION 3.76
REQUIREMENTS <td>SECTION 3.77</td> <td>REQUIREMENTS <td>SECTION 3.77</td> </td>	SECTION 3.77	REQUIREMENTS <td>SECTION 3.77</td>	SECTION 3.77
REQUIREMENTS <td>SECTION 3.78</td> <td>REQUIREMENTS <td>SECTION 3.78</td> </td>	SECTION 3.78	REQUIREMENTS <td>SECTION 3.78</td>	SECTION 3.78
REQUIREMENTS <td>SECTION 3.79</td> <td>REQUIREMENTS <td>SECTION 3.79</td> </td>	SECTION 3.79	REQUIREMENTS <td>SECTION 3.79</td>	SECTION 3.79
REQUIREMENTS <td>SECTION 3.80</td> <td>REQUIREMENTS <td>SECTION 3.80</td> </td>	SECTION 3.80	REQUIREMENTS <td>SECTION 3.80</td>	SECTION 3.80
REQUIREMENTS <td>SECTION 3.81</td> <td>REQUIREMENTS <td>SECTION 3.81</td> </td>	SECTION 3.81	REQUIREMENTS <td>SECTION 3.81</td>	SECTION 3.81
REQUIREMENTS <td>SECTION 3.82</td> <td>REQUIREMENTS <td>SECTION 3.82</td> </td>	SECTION 3.82	REQUIREMENTS <td>SECTION 3.82</td>	SECTION 3.82
REQUIREMENTS <td>SECTION 3.83</td> <td>REQUIREMENTS <td>SECTION 3.83</td> </td>	SECTION 3.83	REQUIREMENTS <td>SECTION 3.83</td>	SECTION 3.83
REQUIREMENTS <td>SECTION 3.84</td> <td>REQUIREMENTS <td>SECTION 3.84</td> </td>	SECTION 3.84	REQUIREMENTS <td>SECTION 3.84</td>	SECTION 3.84
REQUIREMENTS <td>SECTION 3.85</td> <td>REQUIREMENTS <td>SECTION 3.85</td> </td>	SECTION 3.85	REQUIREMENTS <td>SECTION 3.85</td>	SECTION 3.85
REQUIREMENTS <td>SECTION 3.86</td> <td>REQUIREMENTS <td>SECTION 3.86</td> </td>	SECTION 3.86	REQUIREMENTS <td>SECTION 3.86</td>	SECTION 3.86
REQUIREMENTS <td>SECTION 3.87</td> <td>REQUIREMENTS <td>SECTION 3.87</td> </td>	SECTION 3.87	REQUIREMENTS <td>SECTION 3.87</td>	SECTION 3.87
REQUIREMENTS <td>SECTION 3.88</td> <td>REQUIREMENTS <td>SECTION 3.88</td> </td>	SECTION 3.88	REQUIREMENTS <td>SECTION 3.88</td>	SECTION 3.88
REQUIREMENTS <td>SECTION 3.89</td> <td>REQUIREMENTS <td>SECTION 3.89</td> </td>	SECTION 3.89	REQUIREMENTS <td>SECTION 3.89</td>	SECTION 3.89
REQUIREMENTS <td>SECTION 3.90</td> <td>REQUIREMENTS <td>SECTION 3.90</td> </td>	SECTION 3.90	REQUIREMENTS <td>SECTION 3.90</td>	SECTION 3.90
REQUIREMENTS <td>SECTION 3.91</td> <td>REQUIREMENTS <td>SECTION 3.91</td> </td>	SECTION 3.91	REQUIREMENTS <td>SECTION 3.91</td>	SECTION 3.91
REQUIREMENTS <td>SECTION 3.92</td> <td>REQUIREMENTS <td>SECTION 3.92</td> </td>	SECTION 3.92	REQUIREMENTS <td>SECTION 3.92</td>	SECTION 3.92
REQUIREMENTS <td>SECTION 3.93</td> <td>REQUIREMENTS <td>SECTION 3.93</td> </td>	SECTION 3.93	REQUIREMENTS <td>SECTION 3.93</td>	SECTION 3.93
REQUIREMENTS <td>SECTION 3.94</td> <td>REQUIREMENTS <td>SECTION 3.94</td> </td>	SECTION 3.94	REQUIREMENTS <td>SECTION 3.94</td>	SECTION 3.94
REQUIREMENTS <td>SECTION 3.95</td> <td>REQUIREMENTS <td>SECTION 3.95</td> </td>	SECTION 3.95	REQUIREMENTS <td>SECTION 3.95</td>	SECTION 3.95
REQUIREMENTS <td>SECTION 3.96</td> <td>REQUIREMENTS <td>SECTION 3.96</td> </td>	SECTION 3.96	REQUIREMENTS <td>SECTION 3.96</td>	SECTION 3.96
REQUIREMENTS <td>SECTION 3.97</td> <td>REQUIREMENTS <td>SECTION 3.97</td> </td>	SECTION 3.97	REQUIREMENTS <td>SECTION 3.97</td>	SECTION 3.97
REQUIREMENTS <td>SECTION 3.98</td> <td>REQUIREMENTS <td>SECTION 3.98</td> </td>	SECTION 3.98	REQUIREMENTS <td>SECTION 3.98</td>	SECTION 3.98
REQUIREMENTS <td>SECTION 3.99</td> <td>REQUIREMENTS <td>SECTION 3.99</td> </td>	SECTION 3.99	REQUIREMENTS <td>SECTION 3.99</td>	SECTION 3.99
REQUIREMENTS <td>SECTION 3.100</td> <td>REQUIREMENTS <td>SECTION 3.100</td> </td>	SECTION 3.100	REQUIREMENTS <td>SECTION 3.100</td>	SECTION 3.100

OBC MATRIX - BUILDING 'B'

Firm Name: Baldassarra Architects Inc. Certificate of Practice Number: 5810
Address: 1000 SHEPPARD AVE. E. UNIT 107 SCARBOROUGH, ONT. M1B 4E7
Phone: (416) 291-7575

Name of Project: Garden Commercial Building 'B' Aurora, Ontario
Location: _____

Ontario 2012 Building Code Data Matrix Part 3

PROJECT DESCRIPTION	OBC Reference	PROJECT DESCRIPTION	OBC Reference
USE <td>SECTION 3.1</td> <td>USE <td>SECTION 3.1</td> </td>	SECTION 3.1	USE <td>SECTION 3.1</td>	SECTION 3.1
CHANGE OF USE <td>SECTION 3.2</td> <td>CHANGE OF USE <td>SECTION 3.2</td> </td>	SECTION 3.2	CHANGE OF USE <td>SECTION 3.2</td>	SECTION 3.2
MAJOR OCCUPANCY GROUP <td>SECTION 3.3</td> <td>MAJOR OCCUPANCY GROUP <td>SECTION 3.3</td> </td>	SECTION 3.3	MAJOR OCCUPANCY GROUP <td>SECTION 3.3</td>	SECTION 3.3
MINOR OCCUPANCY GROUP <td>SECTION 3.4</td> <td>MINOR OCCUPANCY GROUP <td>SECTION 3.4</td> </td>	SECTION 3.4	MINOR OCCUPANCY GROUP <td>SECTION 3.4</td>	SECTION 3.4
STORY AREA <td>SECTION 3.5</td> <td>STORY AREA <td>SECTION 3.5</td> </td>	SECTION 3.5	STORY AREA <td>SECTION 3.5</td>	SECTION 3.5
FLOOR AREA <td>SECTION 3.6</td> <td>FLOOR AREA <td>SECTION 3.6</td> </td>	SECTION 3.6	FLOOR AREA <td>SECTION 3.6</td>	SECTION 3.6
HEIGHT OF BUILDING <td>SECTION 3.7</td> <td>HEIGHT OF BUILDING <td>SECTION 3.7</td> </td>	SECTION 3.7	HEIGHT OF BUILDING <td>SECTION 3.7</td>	SECTION 3.7
HEIGHT OF SIGN <td>SECTION 3.8</td> <td>HEIGHT OF SIGN <td>SECTION 3.8</td> </td>	SECTION 3.8	HEIGHT OF SIGN <td>SECTION 3.8</td>	SECTION 3.8
NUMBER OF STOREY PROPOSED <td>SECTION 3.9</td> <td>NUMBER OF STOREY PROPOSED <td>SECTION 3.9</td> </td>	SECTION 3.9	NUMBER OF STOREY PROPOSED <td>SECTION 3.9</td>	SECTION 3.9
STAIRS REQUIRED <td>SECTION 3.10</td> <td>STAIRS REQUIRED <td>SECTION 3.10</td> </td>	SECTION 3.10	STAIRS REQUIRED <td>SECTION 3.10</td>	SECTION 3.10
ELEVATOR REQUIRED <td>SECTION 3.11</td> <td>ELEVATOR REQUIRED <td>SECTION 3.11</td> </td>	SECTION 3.11	ELEVATOR REQUIRED <td>SECTION 3.11</td>	SECTION 3.11
PERMITTED CONSTRUCTION <td>SECTION 3.12</td> <td>PERMITTED CONSTRUCTION <td>SECTION 3.12</td> </td>	SECTION 3.12	PERMITTED CONSTRUCTION <td>SECTION 3.12</td>	SECTION 3.12
REQUIREMENTS <td>SECTION 3.13</td> <td>REQUIREMENTS <td>SECTION 3.13</td> </td>	SECTION 3.13	REQUIREMENTS <td>SECTION 3.13</td>	SECTION 3.13
REQUIREMENTS <td>SECTION 3.14</td> <td>REQUIREMENTS <td>SECTION 3.14</td> </td>	SECTION 3.14	REQUIREMENTS <td>SECTION 3.14</td>	SECTION 3.14
REQUIREMENTS <td>SECTION 3.15</td> <td>REQUIREMENTS <td>SECTION 3.15</td> </td>	SECTION 3.15	REQUIREMENTS <td>SECTION 3.15</td>	SECTION 3.15
REQUIREMENTS <td>SECTION 3.16</td> <td>REQUIREMENTS <td>SECTION 3.16</td> </td>	SECTION 3.16	REQUIREMENTS <td>SECTION 3.16</td>	SECTION 3.16
REQUIREMENTS <td>SECTION 3.17</td> <td>REQUIREMENTS <td>SECTION 3.17</td> </td>	SECTION 3.17	REQUIREMENTS <td>SECTION 3.17</td>	SECTION 3.17
REQUIREMENTS <td>SECTION 3.18</td> <td>REQUIREMENTS <td>SECTION 3.18</td> </td>	SECTION 3.18	REQUIREMENTS <td>SECTION 3.18</td>	SECTION 3.18
REQUIREMENTS <td>SECTION 3.19</td> <td>REQUIREMENTS <td>SECTION 3.19</td> </td>	SECTION 3.19	REQUIREMENTS <td>SECTION 3.19</td>	SECTION 3.19
REQUIREMENTS <td>SECTION 3.20</td> <td>REQUIREMENTS <td>SECTION 3.20</td> </td>	SECTION 3.20	REQUIREMENTS <td>SECTION 3.20</td>	SECTION 3.20
REQUIREMENTS <td>SECTION 3.21</td> <td>REQUIREMENTS <td>SECTION 3.21</td> </td>	SECTION 3.21	REQUIREMENTS <td>SECTION 3.21</td>	SECTION 3.21
REQUIREMENTS <td>SECTION 3.22</td> <td>REQUIREMENTS <td>SECTION 3.22</td> </td>	SECTION 3.22	REQUIREMENTS <td>SECTION 3.22</td>	SECTION 3.22
REQUIREMENTS <td>SECTION 3.23</td> <td>REQUIREMENTS <td>SECTION 3.23</td> </td>	SECTION 3.23	REQUIREMENTS <td>SECTION 3.23</td>	SECTION 3.23
REQUIREMENTS <td>SECTION 3.24</td> <td>REQUIREMENTS <td>SECTION 3.24</td> </td>	SECTION 3.24	REQUIREMENTS <td>SECTION 3.24</td>	SECTION 3.24
REQUIREMENTS <td>SECTION 3.25</td> <td>REQUIREMENTS <td>SECTION 3.25</td> </td>	SECTION 3.25	REQUIREMENTS <td>SECTION 3.25</td>	SECTION 3.25
REQUIREMENTS <td>SECTION 3.26</td> <td>REQUIREMENTS <td>SECTION 3.26</td> </td>	SECTION 3.26	REQUIREMENTS <td>SECTION 3.26</td>	SECTION 3.26
REQUIREMENTS <td>SECTION 3.27</td> <td>REQUIREMENTS <td>SECTION 3.27</td> </td>	SECTION 3.27	REQUIREMENTS <td>SECTION 3.27</td>	SECTION 3.27
REQUIREMENTS <td>SECTION 3.28</td> <td>REQUIREMENTS <td>SECTION 3.28</td> </td>	SECTION 3.28	REQUIREMENTS <td>SECTION 3.28</td>	SECTION 3.28
REQUIREMENTS <td>SECTION 3.29</td> <td>REQUIREMENTS <td>SECTION 3.29</td> </td>	SECTION 3.29	REQUIREMENTS <td>SECTION 3.29</td>	SECTION 3.29
REQUIREMENTS <td>SECTION 3.30</td> <td>REQUIREMENTS <td>SECTION 3.30</td> </td>	SECTION 3.30	REQUIREMENTS <td>SECTION 3.30</td>	SECTION 3.30
REQUIREMENTS <td>SECTION 3.31</td> <td>REQUIREMENTS <td>SECTION 3.31</td> </td>	SECTION 3.31	REQUIREMENTS <td>SECTION 3.31</td>	SECTION 3.31
REQUIREMENTS <td>SECTION 3.32</td> <td>REQUIREMENTS <td>SECTION 3.32</td> </td>	SECTION 3.32	REQUIREMENTS <td>SECTION 3.32</td>	SECTION 3.32
REQUIREMENTS <td>SECTION 3.33</td> <td>REQUIREMENTS <td>SECTION 3.33</td> </td>	SECTION 3.33	REQUIREMENTS <td>SECTION 3.33</td>	SECTION 3.33
REQUIREMENTS <td>SECTION 3.34</td> <td>REQUIREMENTS <td>SECTION 3.34</td> </td>	SECTION 3.34	REQUIREMENTS <td>SECTION 3.34</td>	SECTION 3.34
REQUIREMENTS <td>SECTION 3.35</td> <td>REQUIREMENTS <td>SECTION 3.35</td> </td>	SECTION 3.35	REQUIREMENTS <td>SECTION 3.35</td>	SECTION 3.35
REQUIREMENTS <td>SECTION 3.36</td> <td>REQUIREMENTS <td>SECTION 3.36</td> </td>	SECTION 3.36	REQUIREMENTS <td>SECTION 3.36</td>	SECTION 3.36
REQUIREMENTS <td>SECTION 3.37</td> <td>REQUIREMENTS <td>SECTION 3.37</td> </td>	SECTION 3.37	REQUIREMENTS <td>SECTION 3.37</td>	SECTION 3.37
REQUIREMENTS <td>SECTION 3.38</td> <td>REQUIREMENTS <td>SECTION 3.38</td> </td>	SECTION 3.38	REQUIREMENTS <td>SECTION 3.38</td>	SECTION 3.38
REQUIREMENTS <td>SECTION 3.39</td> <td>REQUIREMENTS <td>SECTION 3.39</td> </td>	SECTION 3.39	REQUIREMENTS <td>SECTION 3.39</td>	SECTION 3.39
REQUIREMENTS <td>SECTION 3.40</td> <td>REQUIREMENTS <td>SECTION 3.40</td> </td>	SECTION 3.40	REQUIREMENTS <td>SECTION 3.40</td>	SECTION 3.40
REQUIREMENTS <td>SECTION 3.41</td> <td>REQUIREMENTS <td>SECTION 3.41</td> </td>	SECTION 3.41	REQUIREMENTS <td>SECTION 3.41</td>	SECTION 3.41
REQUIREMENTS <td>SECTION 3.42</td> <td>REQUIREMENTS <td>SECTION 3.42</td> </td>	SECTION 3.42	REQUIREMENTS <td>SECTION 3.42</td>	SECTION 3.42
REQUIREMENTS <td>SECTION 3.43</td> <td>REQUIREMENTS <td>SECTION 3.43</td> </td>	SECTION 3.43	REQUIREMENTS <td>SECTION 3.43</td>	SECTION 3.43
REQUIREMENTS <td>SECTION 3.44</td> <td>REQUIREMENTS <td>SECTION 3.44</td> </td>	SECTION 3.44	REQUIREMENTS <td>SECTION 3.44</td>	SECTION 3.44
REQUIREMENTS <td>SECTION 3.45</td> <td>REQUIREMENTS <td>SECTION 3.45</td> </td>	SECTION 3.45	REQUIREMENTS <td>SECTION 3.45</td>	SECTION 3.45
REQUIREMENTS <td>SECTION 3.46</td> <td>REQUIREMENTS <td>SECTION 3.46</td> </td>	SECTION 3.46	REQUIREMENTS <td>SECTION 3.46</td>	SECTION 3.46
REQUIREMENTS <td>SECTION 3.47</td> <td>REQUIREMENTS <td>SECTION 3.47</td> </td>	SECTION 3.47	REQUIREMENTS <td>SECTION 3.47</td>	SECTION 3.47
REQUIREMENTS <td>SECTION 3.48</td> <td>REQUIREMENTS <td>SECTION 3.48</td> </td>	SECTION 3.48	REQUIREMENTS <td>SECTION 3.48</td>	SECTION 3.48
REQUIREMENTS <td>SECTION 3.49</td> <td>REQUIREMENTS <td>SECTION 3.49</td> </td>	SECTION 3.49	REQUIREMENTS <td>SECTION 3.49</td>	SECTION 3.49
REQUIREMENTS <td>SECTION 3.50</td> <td>REQUIREMENTS <td>SECTION 3.50</td> </td>	SECTION 3.50	REQUIREMENTS <td>SECTION 3.50</td>	SECTION 3.50
REQUIREMENTS <td>SECTION 3.51</td> <td>REQUIREMENTS <td>SECTION 3.51</td> </td>	SECTION 3.51	REQUIREMENTS <td>SECTION 3.51</td>	SECTION 3.51
REQUIREMENTS <td>SECTION 3.52</td> <td>REQUIREMENTS <td>SECTION 3.52</td> </td>	SECTION 3.52	REQUIREMENTS <td>SECTION 3.52</td>	SECTION 3.52
REQUIREMENTS <td>SECTION 3.53</td> <td>REQUIREMENTS <td>SECTION 3.53</td> </td>	SECTION 3.53	REQUIREMENTS <td>SECTION 3.53</td>	SECTION 3.53
REQUIREMENTS <td>SECTION 3.54</td> <td>REQUIREMENTS <td>SECTION 3.54</td> </td>	SECTION 3.54	REQUIREMENTS <td>SECTION 3.54</td>	SECTION 3.54
REQUIREMENTS <td>SECTION 3.55</td> <td>REQUIREMENTS <td>SECTION 3.55</td> </td>	SECTION 3.55	REQUIREMENTS <td>SECTION 3.55</td>	SECTION 3.55
REQUIREMENTS <td>SECTION 3.56</td> <td>REQUIREMENTS <td>SECTION 3.56</td> </td>	SECTION 3.56	REQUIREMENTS <td>SECTION 3.56</td>	SECTION 3.56
REQUIREMENTS <td>SECTION 3.57</td> <td>REQUIREMENTS <td>SECTION 3.57</td> </td>	SECTION 3.57	REQUIREMENTS <td>SECTION 3.57</td>	SECTION 3.57
REQUIREMENTS <td>SECTION 3.58</td> <td>REQUIREMENTS <td>SECTION 3.58</td> </td>	SECTION 3.58	REQUIREMENTS <td>SECTION 3.58</td>	SECTION 3.58
REQUIREMENTS <td>SECTION 3.59</td> <td>REQUIREMENTS <td>SECTION 3.59</td> </td>	SECTION 3.59	REQUIREMENTS <td>SECTION 3.59</td>	SECTION 3.59
REQUIREMENTS <td>SECTION 3.60</td> <td>REQUIREMENTS <td>SECTION 3.60</td> </td>	SECTION 3.60	REQUIREMENTS <td>SECTION 3.60</td>	SECTION 3.60
REQUIREMENTS <td>SECTION 3.61</td> <td>REQUIREMENTS <td>SECTION 3.61</td> </td>	SECTION 3.61	REQUIREMENTS <td>SECTION 3.61</td>	SECTION 3.61
REQUIREMENTS <td>SECTION 3.62</td> <td>REQUIREMENTS <td>SECTION 3.62</td> </td>	SECTION 3.62	REQUIREMENTS <td>SECTION 3.62</td>	SECTION 3.62
REQUIREMENTS <td>SECTION 3.63</td> <td>REQUIREMENTS <td>SECTION 3.63</td> </td>	SECTION 3.63	REQUIREMENTS <td>SECTION 3.63</td>	SECTION 3.63
REQUIREMENTS <td>SECTION 3.64</td> <td>REQUIREMENTS <td>SECTION 3.64</td> </td>	SECTION 3.64	REQUIREMENTS <td>SECTION 3.64</td>	SECTION 3.64
REQUIREMENTS <td>SECTION 3.65</td> <td>REQUIREMENTS <td>SECTION 3.65</td> </td>	SECTION 3.65	REQUIREMENTS <td>SECTION 3.65</td>	SECTION 3.65
REQUIREMENTS <td>SECTION 3.66</td> <td>REQUIREMENTS <td>SECTION 3.66</td> </td>	SECTION 3.66	REQUIREMENTS <td>SECTION 3.66</td>	SECTION 3.66
REQUIREMENTS <td>SECTION 3.67</td> <td>REQUIREMENTS <td>SECTION 3.67</td> </td>	SECTION 3.67	REQUIREMENTS <td>SECTION 3.67</td>	SECTION 3.67
REQUIREMENTS <td>SECTION 3.68</td> <td>REQUIREMENTS <td>SECTION 3.68</td> </td>	SECTION 3.68	REQUIREMENTS <td>SECTION 3.68</td>	SECTION 3.68
REQUIREMENTS <td>SECTION 3.69</td> <td>REQUIREMENTS <td>SECTION 3.69</td> </td>	SECTION 3.69	REQUIREMENTS <td>SECTION 3.69</td>	SECTION 3.69
REQUIREMENTS <td>SECTION 3.70</td> <td>REQUIREMENTS <td>SECTION 3.70</td> </td>	SECTION 3.70	REQUIREMENTS <td>SECTION 3.70</td>	SECTION 3.70
REQUIREMENTS <td>SECTION 3.71</td> <td>REQUIREMENTS <td>SECTION 3.71</td> </td>	SECTION 3.71	REQUIREMENTS <td>SECTION 3.71</td>	SECTION 3.71
REQUIREMENTS <td>SECTION 3.72</td> <td>REQUIREMENTS <td>SECTION 3.72</td> </td>	SECTION 3.72	REQUIREMENTS <td>SECTION 3.72</td>	SECTION 3.72
REQUIREMENTS <td>SECTION 3.73</td> <td>REQUIREMENTS <td>SECTION 3.73</td> </td>	SECTION 3.73	REQUIREMENTS <td>SECTION 3.73</td>	SECTION 3.73
REQUIREMENTS <td>SECTION 3.74</td> <td>REQUIREMENTS <td>SECTION 3.74</td> </td>	SECTION 3.74	REQUIREMENTS <td>SECTION 3.74</td>	SECTION 3.74
REQUIREMENTS <td>SECTION 3.75</td> <td>REQUIREMENTS <td>SECTION 3.75</td> </td>	SECTION 3.75	REQUIREMENTS <td>SECTION 3.75</td>	SECTION 3.75
REQUIREMENTS <td>SECTION 3.76</td> <td>REQUIREMENTS <td>SECTION 3.76</td> </td>	SECTION 3.76	REQUIREMENTS <td>SECTION 3.76</td>	SECTION 3.76
REQUIREMENTS <td>SECTION 3.77</td> <td>REQUIREMENTS <td>SECTION 3.77</td> </td>	SECTION 3.77	REQUIREMENTS <td>SECTION 3.77</td>	SECTION 3.77
REQUIREMENTS <td>SECTION 3.78</td> <td>REQUIREMENTS <td>SECTION 3.78</td> </td>	SECTION 3.78	REQUIREMENTS <td>SECTION 3.78</td>	SECTION 3.78
REQUIREMENTS <td>SECTION 3.79</td> <td>REQUIREMENTS <td>SECTION 3.79</td> </td>	SECTION 3.79	REQUIREMENTS <td>SECTION 3.79</td>	SECTION 3.79
REQUIREMENTS <td>SECTION 3.80</td> <td>REQUIREMENTS <td>SECTION 3.80</td> </td>	SECTION 3.80	REQUIREMENTS <td>SECTION 3.80</td>	SECTION 3.80
REQUIREMENTS <td>SECTION 3.81</td> <td>REQUIREMENTS <td>SECTION 3.81</td> </td>	SECTION 3.81	REQUIREMENTS <td>SECTION 3.81</td>	SECTION 3.81
REQUIREMENTS <td>SECTION 3.82</td> <td>REQUIREMENTS <td>SECTION 3.82</td> </td>	SECTION 3.82	REQUIREMENTS <td>SECTION 3.82</td>	SECTION 3.82
REQUIREMENTS <td>SECTION 3.83</td> <td>REQUIREMENTS <td>SECTION 3.83</td> </td>	SECTION 3.83	REQUIREMENTS <td>SECTION 3.83</td>	SECTION 3.83
REQUIREMENTS <td>SECTION 3.84</td> <td>REQUIREMENTS <td>SECTION 3.84</td> </td>	SECTION 3.84	REQUIREMENTS <td>SECTION 3.84</td>	SECTION 3.84
REQUIREMENTS <td>SECTION 3.85</td> <td>REQUIREMENTS <td>SECTION 3.85</td> </td>	SECTION 3.85	REQUIREMENTS <td>SECTION 3.85</td>	SECTION 3.85
REQUIREMENTS <td>SECTION 3.86</td> <td>REQUIREMENTS <td>SECTION 3.86</td> </td>	SECTION 3.86	REQUIREMENTS <td>SECTION 3.86</td>	SECTION 3.86
REQUIREMENTS <td>SECTION 3.87</td> <td>REQUIREMENTS <td>SECTION 3.87</td> </td>	SECTION 3.87	REQUIREMENTS <td>SECTION 3.87</td>	SECTION 3.87
REQUIREMENTS <td>SECTION 3.88</td> <td>REQUIREMENTS <td>SECTION 3.88</td> </td>	SECTION 3.88	REQUIREMENTS <td>SECTION 3.88</td>	SECTION 3.88
REQUIREMENTS <td>SECTION 3.89</td> <td>REQUIREMENTS <td>SECTION 3.89</td> </td>	SECTION 3.89	REQUIREMENTS <td>SECTION 3.89</td>	SECTION 3.89
REQUIREMENTS <td>SECTION 3.90</td> <td>REQUIREMENTS <td>SECTION 3.90</td> </td>	SECTION 3.90	REQUIREMENTS <td>SECTION 3.90</td>	SECTION 3.90
REQUIREMENTS <td>SECTION 3.91</td> <td>REQUIREMENTS <td>SECTION 3.91</td> </td>	SECTION 3.91	REQUIREMENTS <td>SECTION 3.91</td>	SECTION 3.91
REQUIREMENTS <td>SECTION 3.92</td> <td>REQUIREMENTS <td>SECTION 3.92</td> </td>	SECTION 3.92	REQUIREMENTS <td>SECTION 3.92</td>	SECTION 3.92
REQUIREMENTS <td>SECTION 3.93</td> <td>REQUIREMENTS <td>SECTION 3.93</td> </td>	SECTION 3.93	REQUIREMENTS <td>SECTION 3.93</td>	SECTION 3.93
REQUIREMENTS <td>SECTION 3.94</td> <td>REQUIREMENTS <td>SECTION 3.94</td> </td>	SECTION 3.94	REQUIREMENTS <td>SECTION 3.94</td>	SECTION 3.94
REQUIREMENTS <td>SECTION 3.95</td> <td>REQUIREMENTS <td>SECTION 3.95</td> </td>	SECTION 3.95	REQUIREMENTS <td>SECTION 3.95</td>	SECTION 3.95
REQUIREMENTS <td>SECTION 3.96</td> <td>REQUIREMENTS <td>SECTION 3.96</td> </td>	SECTION 3.96	REQUIREMENTS <td>SECTION 3.96</td>	SECTION 3.96
REQUIREMENTS <td>SECTION 3.97</td> <td>REQUIREMENTS <td>SECTION 3.97</td> </td>	SECTION 3.97	REQUIREMENTS <td>SECTION 3.97</td>	SECTION 3.97
REQUIREMENTS <td>SECTION 3.98</td> <td>REQUIREMENTS <td>SECTION 3.98</td> </td>	SECTION 3.98	REQUIREMENTS <td>SECTION 3.98</td>	SECTION 3.98
REQUIREMENTS <td>SECTION 3.99</td> <td>REQUIREMENTS <td>SECTION 3.99</td> </td>	SECTION 3.99	REQUIREMENTS <td>SECTION 3.99</td>	SECTION 3.99
REQUIREMENTS <td>SECTION 3.100</td> <td>REQUIREMENTS <td>SECTION 3.100</td> </td>	SECTION 3.100	REQUIREMENTS <td>SECTION 3.100</td>	SECTION 3.100

SITE STATISTICS

SITE AREA	25,375.85 m ² or 6.27 Ac
ZONING	EMPLOYMENT ZONE - GENERAL (E2)
FRONT YARD	REQUIRED: 3.0 m PROVIDED: 3.0 m
INTERIOR SIDE YARD	REQUIRED: 3.0 m PROVIDED: 12.0 m
REAR YARD	REQUIRED: 9.0 m PROVIDED: 45.46 m
EXTERIOR SIDE YARD	REQUIRED: 3.0 m PROVIDED: 20.70 m
BUILDING HEIGHT (metres)	REQUIRED: 15.0 m (MAX) PROVIDED: 9.95 m
BUILDING HEIGHT (storeys)	REQUIRED: 5 PROVIDED: 1 Storey
BUILDING 'A' GROUND FLOOR MEZZANINE	2,090.37 m ² or 1,582.55 m ² or 507.82 m ² or 27,428 sqft or 20,104 sqft or 7,324 sqft
BUILDING 'B' GROUND FLOOR MEZZANINE	2,548.16 m ² or 1,867.72 m ² or 577.44 m ² or 27,428 sqft or 20,104 sqft or 7,324 sqft
TOTAL GFA	4,638.53 m² or 49,928 sqft
SITE COVERAGE	3,450.27 m ² or 13.60 %
LANDSCAPED AREA	16,329.88 m ² or 64.35 %
PAVED AREA	5,595.70 m ² or 22.05 %
INDUSTRIAL USES	REQUIRED: 1.5 Spaces / 100 m ² GFA PROVIDED: 70 Spaces
FUTURE EV SPACES	REQUIRED: 14 Spaces PROVIDED: 14 Spaces
ACCESSIBLE PARKING	REQUIRED: 3 Spaces PROVIDED: 6 Spaces
BI-CYCLE PARKING	REQUIRED: 4 Spaces PROVIDED: 4 Spaces
LOADING SPACES	REQUIRED: 2 Spaces PROVIDED: 2 Spaces
SNOW STORAGE AREA (sq. ft. OF PAVED AREA)	315.54 m ²

