

# SCHEDULE 'B' TO BY-LAW 6000-17 KEY NATURAL HERITAGE FEATURES & HYDROLOGICALLY SENSITIVE FEATURES MAP NO. 7

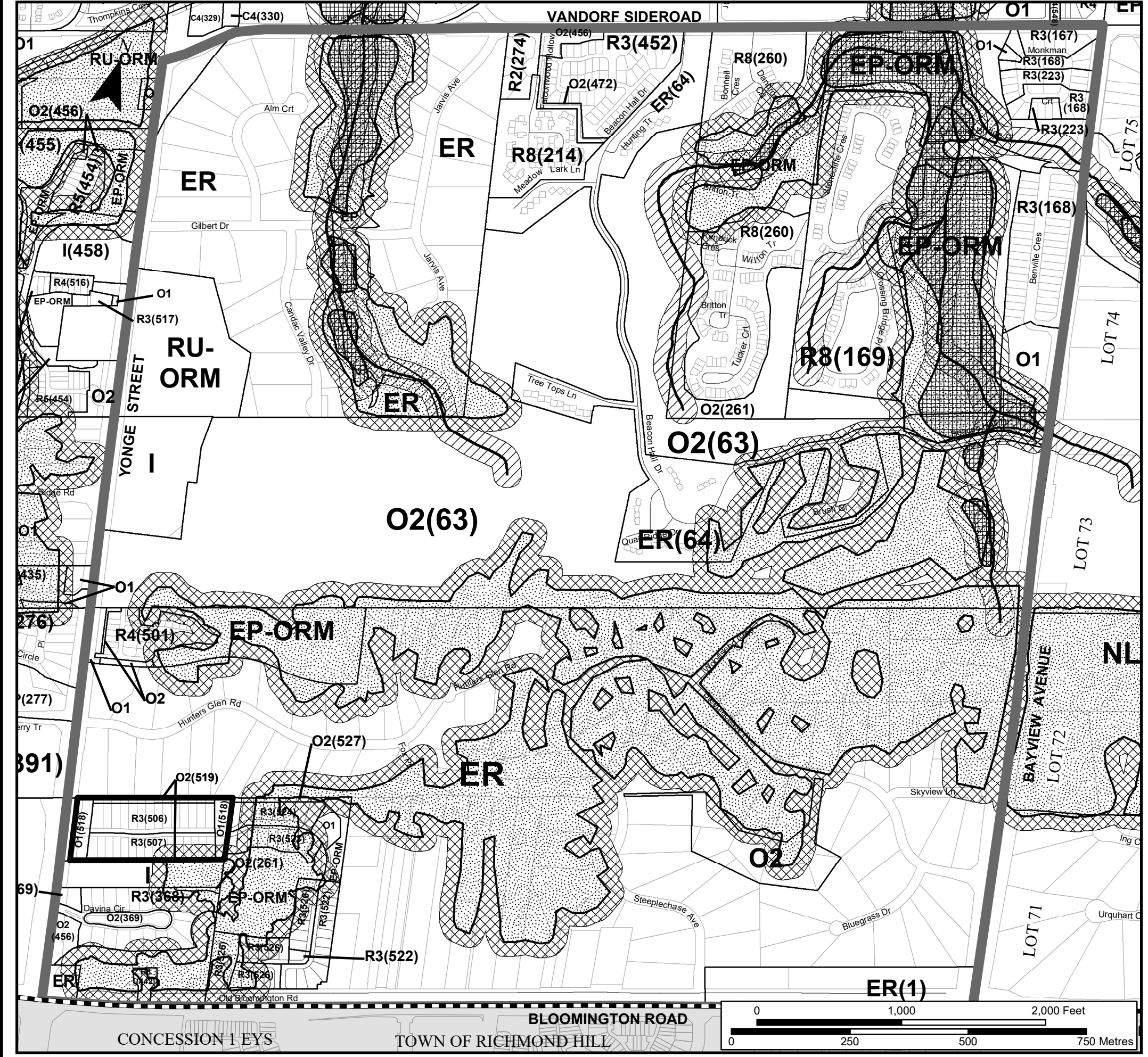

ZONING LEGEND		
<b>RESIDENTIAL ZONES</b>	<b>COMMERCIAL ZONES</b>	<b>OPEN SPACE ZONES</b>
<b>ER</b> Estate Residential	<b>C1</b> Convenience Commercial	<b>EP</b> Environmental Protection
<b>ER-ORM</b> Oak Ridges Moraine Estate Residential	<b>C2</b> Central Commercial	<b>EP-ORM</b> Oak Ridges Moraine Environmental Protection
<b>R1</b> Detached First Density Residential	<b>C3</b> Service Commercial	<b>O1</b> Public Open Space
<b>R2</b> Detached Second Density Residential	<b>C4</b> Community Commercial	<b>O2</b> Private Open Space
<b>R3</b> Detached Third Density Residential	<b>C5</b> Major Retail	<b>O-ORM</b> Oak Ridges Moraine Open Space
<b>R4</b> Detached Fourth Density Residential	<b>C6</b> Mixed Residential Commercial	<b>ORM COUNTRYSIDE AREA</b>
<b>R5</b> Detached Fifth Density Residential	<b>C7</b> Residential	<b>C-ORM</b> Oak Ridges Moraine Countryside Area
<b>R6</b> Semi-Detached and Duplex Dwelling Residential	<b>PROMENADE ZONES</b>	<b>ORM NATURAL CORE AREA</b>
<b>R7</b> Special Mixed Density Residential	<b>PD1</b> Promenade Downtown	<b>NC-ORM</b> Oak Ridges Moraine Natural Core Area
<b>R8</b> Townhouse Dwelling Residential	<b>PD2</b> Promenade Downtown - Special Mixed Density Residential	<b>ORM NATURAL LINKAGE AREA</b>
<b>RA1</b> First Density Apartment Residential	<b>PDS1</b> Promenade Downtown Shoulder - Central Commercial	<b>NL-ORM</b> Oak Ridges Moraine Natural Linkage Area
<b>RA2</b> Second Density Apartment Residential	<b>PDS2</b> Promenade Downtown Shoulder - Service Commercial	<b>KNHF &amp; HYDROLOGICALLY SENSITIVE FEATURES AND MVPZ EXCEPTION 1 ZONE</b>
<b>EMPLOYMENT ZONES</b>	<b>PDS3</b> Promenade Downtown Shoulder - Institutional	<b>KNHF-1 Zone</b> KNHF & Hydrologically Sensitive Features Exception 1 Zone
<b>E1</b> Service Employment	<b>PDS4</b> Promenade Downtown Shoulder - Special Mixed Density Residential	<b>MVPZ-1 Zone</b> MVPZ Exception 1 Zone
<b>E2</b> General Employment	<b>RURAL ZONES</b>	
<b>E-BP</b> Business Park	<b>RU</b> Rural	
<b>INSTITUTIONAL ZONES</b>	<b>RU-ORM</b> Oak Ridges Moraine Rural	
<b>I</b> Institutional		

**Note: Zoning Classifications and Provisions refer to Comprehensive Zoning By-law text document**

LEGEND	
	Oak Ridges Moraine Conservation Plan Area
	Boundary of Oak Ridges Moraine Conservation Plan Area Ontario Regulation 140/02
	Boundary of Oak Ridges Moraine Area Ontario Regulation 01/02
	Map #7 Area
	Municipal Boundary
	Lot
	Railway
	Hydro Corridor
	Under Appeal to the Ontario Municipal Board
	Wetland
	Wetland MVPZ
	Permanent and Intermittent Streams
	Permanent and Intermittent Streams MVPZ
	Waterbodies
	Area of Natural and Scientific Interest (Life Science)
	Woodlands
	Woodlands MVPZ
	MVPZ = Minimum Vegetation Protection Zone

**By-Law 6000-17 consists of Schedules "A" to "E" inclusive and accordingly each schedule shall be considered in the determination of zoning provisions pertaining to individual properties.**

NOTE: ZONING LINES AND PROPERTY LINES SHOWN ARE FOR INFORMATION PURPOSES ONLY. REFERENCE SHOULD BE MADE TO THE CORRESPONDING BY-LAWS AND REGISTERED PLANS.

THE BOUNDARIES OF THE ENVIRONMENTAL PROTECTION ZONE AND THE FILL AND CONSTRUCTION AREA WERE PLOTTED FROM MAPPING FROM THE LAKE SIMCOE REGION CONSERVATION AUTHORITY WHICH WAS PREPARED USING THE CRITERIA IN ONTARIO REGULATION 782/74. FOR MORE ACCURATE LOCATION REFERENCE SHOULD BE MADE TO THE ORIGINAL MAPPING. BASE INFORMATION PROVIDED BY THE REGION OF YORK.

<b>AURORA</b> <i>You're in Good Company</i>		
DRAWN BY: ML	UPDATED BY: JS	APPROVED BY: ML
CREATED DATE: 05/2017	DATE UPDATED: 1/2024	FILE NAME: Schedule B KNHF Map 7

